

**T<sub>aper</sub>  
B<sub>ore</sub>** HTP *Timing pulley*

**QTL**

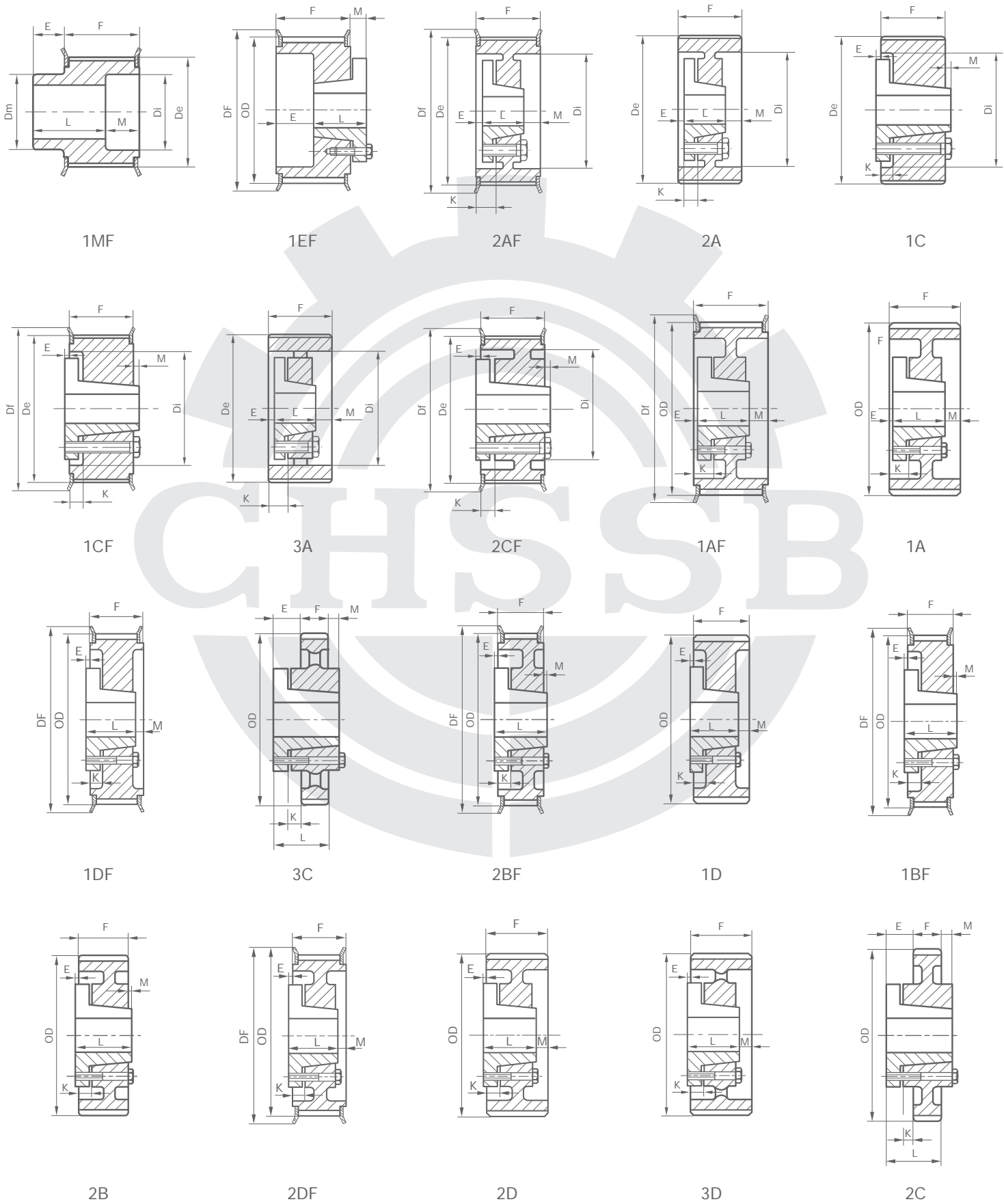

**T<sub>aper</sub>  
B<sub>ore</sub>** HTP *Timing pulley*



**QTL**

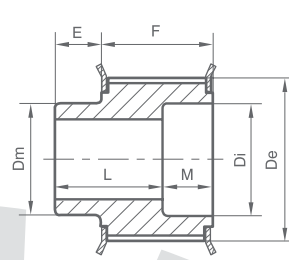

1MF

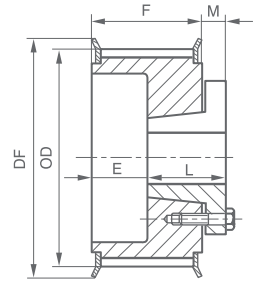

1EF

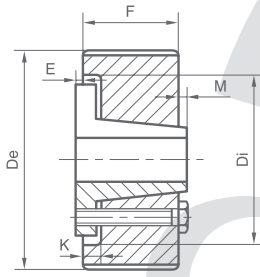

1C

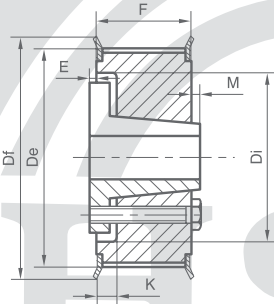

1CF

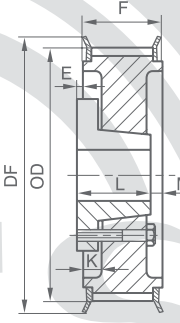

1DF

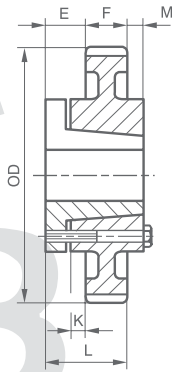

2C

**HTP 5M-15**

SPCFCTN	TYPE	BUSH	Z	Diameter					Dimension					wt (lbs)
				Dp	De	Df	Dm	Di	E	M	L	F	K	
32-5M15F	1MF	-	32	2.005	1.960	23/16	19/16	—	0.50	—	1.34	0.84	—	0.84
34-5M15F	1MF	-	34	2.130	2.085	29/32	111/16	—	0.50	—	1.34	0.84	—	0.93
36-5M15F	1MF	-	36	2.256	2.211	213/32	113/16	—	0.50	—	1.34	0.84	—	1.03
JA38-5M15F	1EF	JA	38	2.381	2.336	217/32	—	111/32	0.28	0.44	1.00	0.84	—	0.61
JA40-5M15F	1EF	JA	40	2.506	2.461	221/32	—	111/32	0.28	0.44	1.00	0.84	—	0.72
JA44-5M15F	1EF	JA	44	2.757	2.712	229/32	—	111/32	0.28	0.44	1.00	0.84	—	0.95
JA48-5M15F	1CF	JA	48	3.008	2.963	33/16	—	223/64	0.16	—	1.00	0.84	0.28	0.97
JA52-5M15F	1CF	JA	52	3.258	3.213	313/32	—	25/8	0.16	—	1.00	0.84	0.28	1.17
SH56-5M15F	1DF	SH	56	3.509	3.464	321/32	—	—	0.50	0.09	1.25	0.84	—	1.37
SH60-5M15F	1DF	SH	60	3.760	3.715	315/16	—	—	0.50	0.09	1.25	0.84	—	1.68
SH64-5M15F	1DF	SH	64	4.010	3.965	43/16	—	—	0.50	0.09	1.25	0.84	—	1.80
SDS68-5M15F	1CF	SDS	68	4.261	4.216	413/32	—	31/2	0.47	—	1.31	0.84	0.09	2.10
SDS72-5M15F	1CF	SDS	72	4.511	4.466	421/32	—	33/4	0.47	—	1.31	0.84	0.09	2.43
SDS80-5M15	1C	SDS	80	5.013	4.968	—	—	41/4	0.47	—	1.31	0.84	0.09	3.15
SDS90-5M15	1C	SDS	90	5.639	5.594	—	—	47/8	0.47	—	1.31	0.84	0.09	4.17
SDS112-5M15	1C	SDS	112	7.018	6.973	—	3 1/2	6	0.47	—	1.31	0.84	0.09	5.16

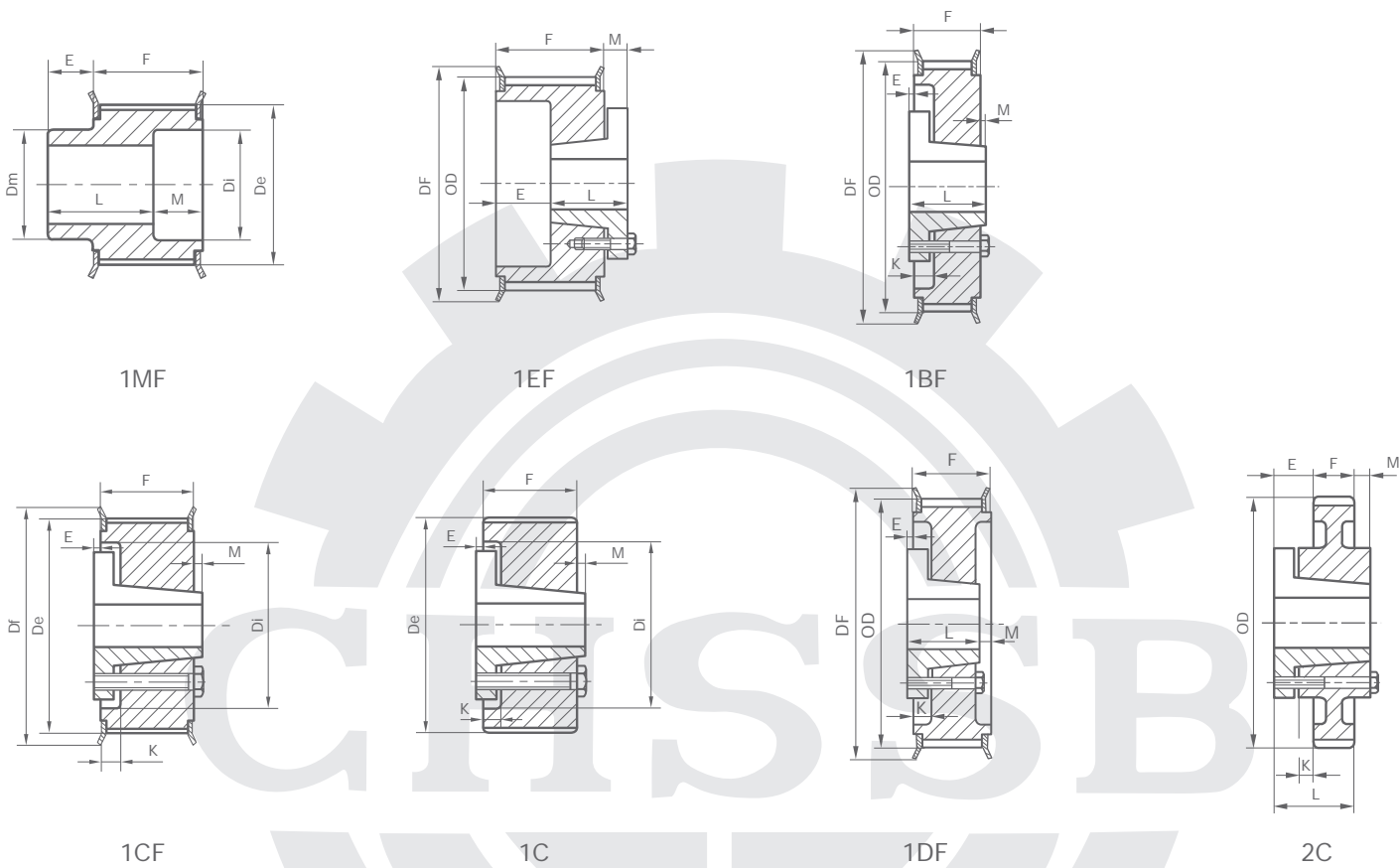

**HTP 5M-25**

SPCFCTN	TYPE	BUSH	Z	Diameter					Dimension					wt (lbs)
				Dp	De	Df	Dm	Di	E	M	L	F	K	
32-5M25F	1MF	—	32	2.005	1.960	23/16	19/16	—	0.50	—	1.73	1.23	—	1.12
34-5M25F	1MF	—	34	2.130	2.085	29/32	111/16	—	0.50	—	1.73	1.23	—	1.25
36-5M25F	1MF	—	36	2.256	2.211	213/32	113/16	—	0.50	—	1.73	1.23	—	1.39
JA38-5M25F	1EF	JA	38	2.381	2.336	217/32	—	111/32	0.67	0.44	1.00	1.23	—	0.80
JA40-5M25F	1EF	JA	40	2.506	2.461	221/32	—	111/32	0.67	0.44	1.00	1.23	—	1.06
JA44-5M25F	1EF	JA	44	2.757	2.712	229/32	—	111/32	0.67	0.44	1.00	1.23	—	1.40
JA48-5M25F	1BF	JA	48	3.008	2.963	33/16	—	223/64	0.23	—	1.00	1.23	0.67	1.20
JA52-5M25F	1BF	JA	52	3.258	3.213	313/32	—	25/8	0.23	—	1.00	1.23	0.67	1.43
SH56-5M25F	1DF	SH	56	3.509	3.464	321/32	—	213/16	0.08	0.06	1.25	1.23	0.42	1.64
SH60-5M25F	1DF	SH	60	3.760	3.715	315/16	—	31/8	0.08	0.06	1.25	1.23	0.42	1.83
SH64-5M25F	1DF	SH	64	4.010	3.965	43/16	—	33/8	0.08	0.06	1.25	1.23	0.42	2.16
SDS68-5M25F	1CF	SDS	68	4.261	4.216	413/32	—	31/2	0.08	—	1.31	1.23	0.48	2.48
SDS72-5M25F	1CF	SDS	72	4.511	4.466	421/32	—	33/4	0.08	—	1.31	1.23	0.48	2.84
SDS80-5M25	1C	SDS	80	5.013	4.968	—	—	41/4	0.08	—	1.31	1.23	0.48	3.61
SDS90-5M25	1C	SDS	90	5.639	5.594	—	—	47/8	0.08	—	1.31	1.23	0.48	4.69
SDS112-5M25	2C	SDS	112	7.018	6.973	—	31/2	6	0.08	—	1.31	1.23	0.48	6.02

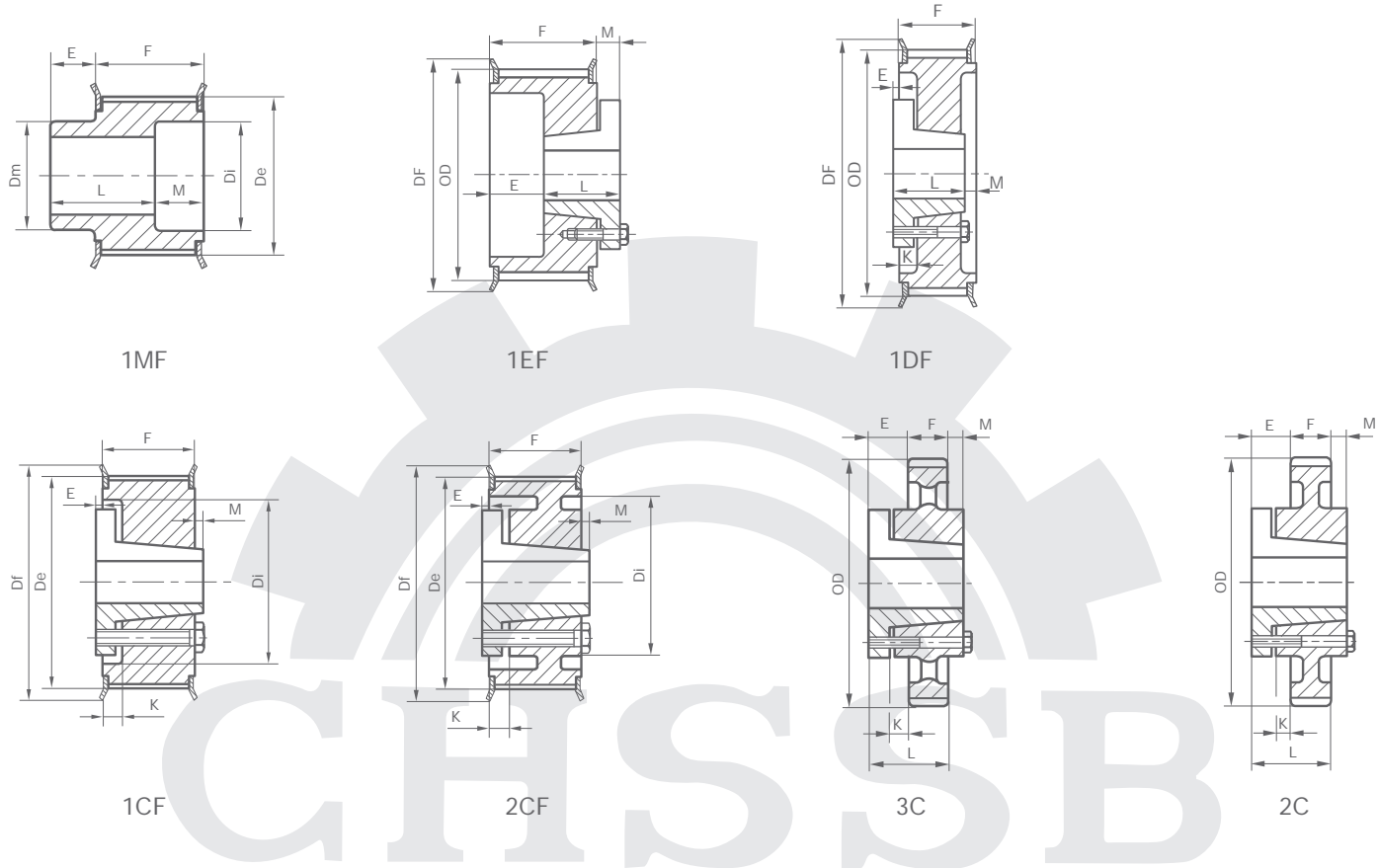

**HTP 8M-20**

SPCFCTN	TYPE	BUSH	Z	Diameter					Dimension					wt (lbs)
				Dp	De	Df	Dm	Di	E	M	L	F	K	
20-8M20F	1MF	—	20	2.005	1.951	23/8	13/8	—	5/8	—	13/4	11/8	—	0.90
21-8M20F	1MF	—	21	2.105	2.051	27/16	11/2	—	5/8	—	13/4	11/8	—	1.00
22-8M20F	1MF	—	22	2.206	2.152	29/16	15/8	—	5/8	—	13/4	11/8	—	1.60
JA24-8M20F	1EF	JA	24	2.406	2.352	23/4	—	111/32	9/16	7/16	11/16	11/8	—	1.50
JA26-8M20F	1EF	JA	26	2.607	2.553	215/16	—	111/32	9/16	7/16	11/16	11/8	—	1.80
H28-8M20F	1EF	H	28	2.807	2.753	35/32	—	19/16	1/4	3/8	11/4	11/8	—	1.85
H30-8M20F	1EF	H	30	3.008	2.954	311/32	—	19/16	1/4	3/8	11/4	11/8	—	1.90
H32-8M20F	1CF	H	32	3.208	3.154	39/16	—	29/16	1/8	—	11/4	11/8	1/4	2.00
SH34-8M20F	1DF	SH	34	3.409	3.355	33/4	—	23/4	3/16	1/16	11/4	11/8	5/16	2.20
SH36-8M20F	1DF	SH	36	3.609	3.555	315/16	—	213/16	3/16	1/16	11/4	11/8	5/16	2.50
SH38-8M20F	1DF	SH	38	3.810	3.756	45/32	—	3	3/16	1/16	11/4	11/8	5/16	2.80
SH40-8M20F	1DF	SH	40	4.010	3.956	411/32	—	3	3/16	1/16	11/4	11/8	5/16	3.40
SDS44-8M20F	1CF	SDS	44	4.411	4.357	43/4	—	31/2	3/16	—	15/16	11/8	3/8	3.20
SDS48-8M20F	1CF	SDS	48	4.812	4.758	53/16	—	313/16	3/16	—	15/16	11/8	3/8	3.40
SDS56-8M20F	1CF	SDS	56	5.614	5.560	515/16	—	49/16	3/16	—	15/16	11/8	3/8	4.50
SDS64-8M20F	1CF	SDS	64	6.416	6.362	63/4	—	53/8	3/16	—	15/16	11/8	3/8	—
SDS72-8M20F	1CF	SDS	72	7.218	7.164	79/16	—	63/16	3/16	—	15/16	11/8	3/8	6.00
SDS80-8M20F	2CF	SDS	80	8.020	7.966	83/8	31/2	67/8	3/16	—	15/16	11/8	3/8	6.50
SDS90-8M20	2D	SDS	90	9.023	8.969	—	31/2	75/8	3/16	—	15/16	11/8	3/8	7.00
SK112-8M20	3C	SK	112	11.229	11.175	—	43/8	97/8	3/4	1/16	15/16	11/8	1/16	10.50
SF144-8M20	3C	SF	144	14.447	14.383	—	5	127/8	3/4	1/16	21/16	11/8	1/16	14.50



**T<sub>aper</sub>  
B<sub>ore</sub>** HTP *Timing pulley*

**QTL**

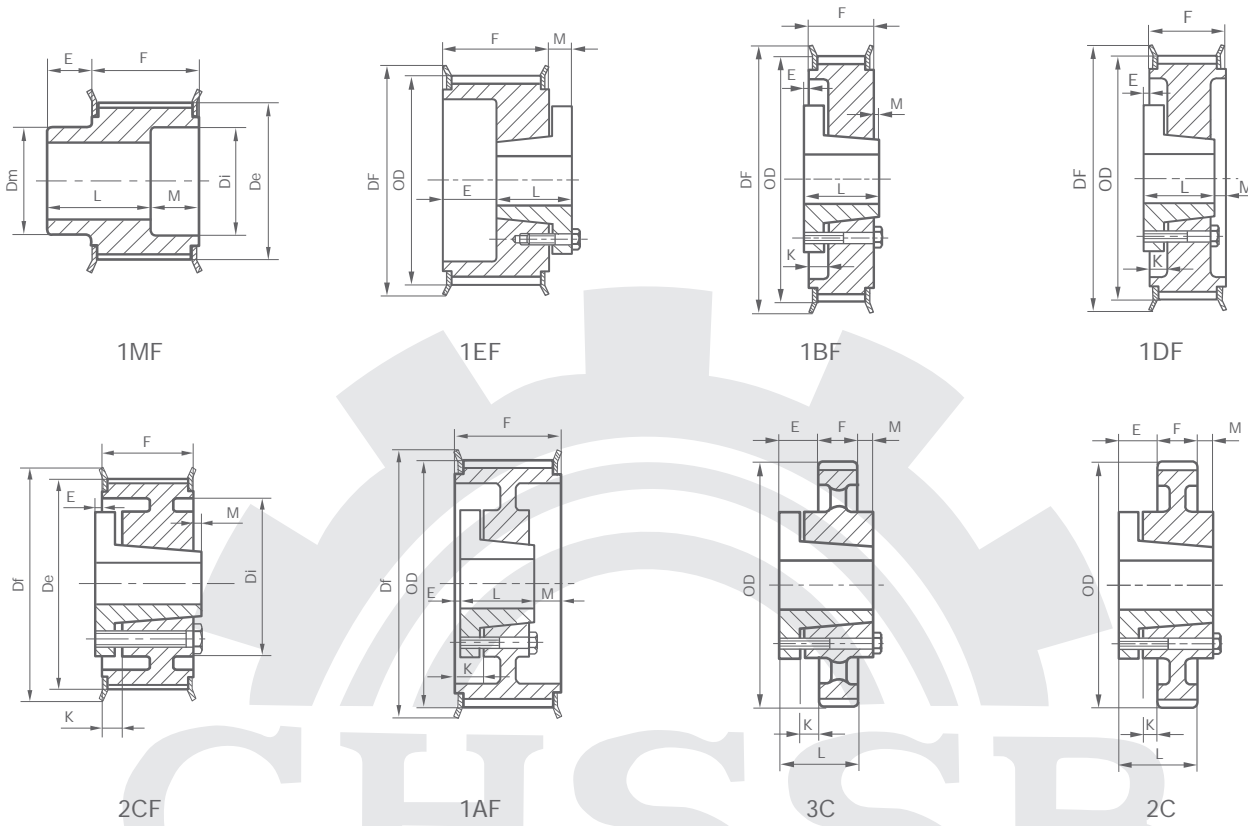

**HTP 8M-30**

SPCFCTN	TYPE	BUSH	Z	Diameter					Dimension					wt (lbs)
				Dp	De	Df	Dm	Di	E	M	L	F	K	
20-8M30F	1MF	—	20	2.005	1.951	23/8	13/8	—	5/8	—	21/8	11/2	—	1.1
21-8M30F	1MF	—	21	2.105	2.051	27/16	11/2	—	5/8	—	21/8	11/2	—	1.3
22-8M30F	1MF	—	22	2.206	2.152	29/16	15/8	—	5/8	—	21/8	11/2	—	1.4
24-8M30F	1MF	—	24	2.406	2.352	23/4	113/16	—	5/8	—	21/8	11/2	—	1.8
26-8M30F	1MF	—	26	2.607	2.553	215/16	2	—	5/8	—	21/8	11/2	—	2.2
H28-8M30F	1EF	H	28	2.807	2.753	35/32	—	19/16	5/8	3/8	11/4	11/2	—	1.7
H30-8M30F	1EF	H	30	3.008	2.954	311/32	—	19/16	5/8	3/8	11/4	11/2	—	1.9
H32-8M30F	1BF	H	32	3.208	3.154	39/16	—	29/16	1/4	—	11/4	11/2	5/8	2.1
SH34-8M30F	1AF	SH	34	3.409	3.355	33/4	—	23/4	3/16	1/16	11/4	11/2	11/16	2.4
SH36-8M30F	1AF	SH	36	3.609	3.555	315/16	—	213/16	3/16	1/16	11/4	11/2	11/16	2.8
SH38-8M30F	1AF	SH	38	3.810	3.756	45/32	—	3	3/16	1/16	11/4	11/2	11/16	3.2
SH40-8M30F	1AF	SH	40	4.010	3.956	411/32	—	3	3/16	1/16	11/4	11/2	11/16	3.6
SDS44-8M30F	1BF	SDS	44	4.411	4.357	43/4	—	31/2	3/16	—	15/16	11/2	3/4	3.8
SDS48-8M30F	1BF	SDS	48	4.812	4.758	53/16	—	313/16	3/16	—	15/16	11/2	3/4	4.2
SDS56-8M30F	1BF	SDS	56	5.614	5.560	515/16	—	49/16	3/16	—	15/16	11/2	3/4	4.8
SK64-8M30F	1CF	SK	64	6.416	6.362	63/4	—	53/8	3/8	—	17/8	11/2	1/4	6.1
SK72-8M30F	1CF	SK	72	7.218	7.164	79/16	—	63/16	3/8	—	17/8	11/2	1/4	6.8
SK80-8M30F	2CF	SK	80	8.020	7.966	83/8	43/8	67/8	3/8	—	17/8	11/2	1/4	7.5
SK90-8M30	2D	SK	90	9.023	8.969	—	43/8	75/8	3/8	—	17/8	11/2	1/4	11.0
SK112-8M30	3D	SK	112	11.229	11.175	—	43/8	97/8	3/8	—	17/8	11/2	1/4	13.0
SF144-8M30	3D	SF	144	14.447	14.383	—	5	127/8	9/16	—	21/16	11/2	1/4	25.5
E192-8M30	3C	E	192	19.249	19.195	—	61/4	175/8	15/16	1/16	25/8	11/2	1/16	30.0

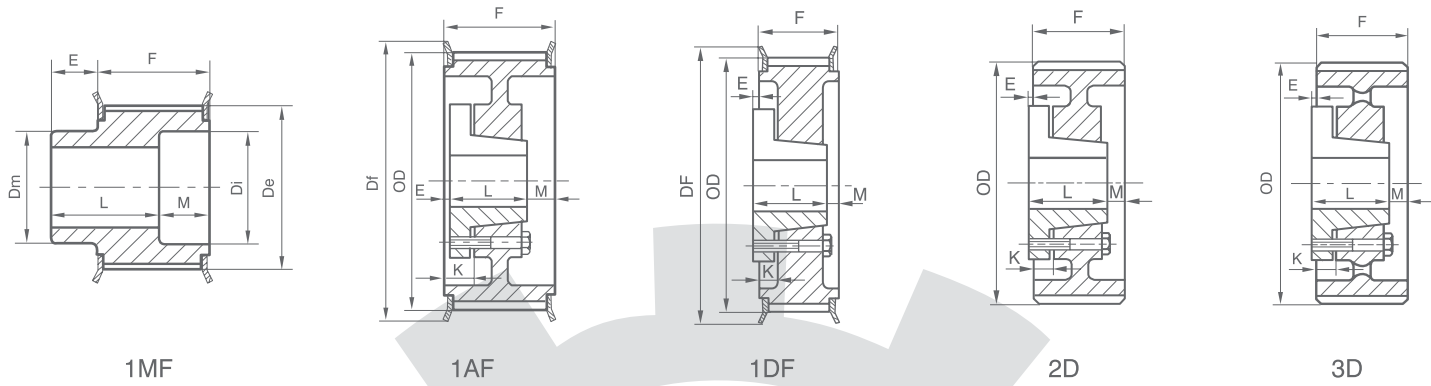

**HTP 8M-50**

SPCFCTN	TYPE	BUSH	Z	Diameter					Dimension					wt (lbs)
				Dp	De	Df	Dm	Di	E	M	L	F	K	
28-8M50F	1MF	—	28	2.807	2.753	33/16	29/16	—	3/4	—	31/8	23/8	—	4.2
30-8M50F	1MF	—	30	3.008	2.954	35/16	215/32	—	3/4	—	31/8	23/8	—	4.9
32-8M50F	1MF	—	32	3.208	3.154	39/16	219/32	—	3/4	—	31/8	23/8	—	5.4
H32-8M50F	1AF	H	32	3.208	3.154	39/16	—	29/16	1/2	5/8	11/4	23/8	3/4	2.9
SH34-8M50F	1AF	SH	34	3.409	3.355	33/4	—	23/4	—	11/8	11/4	23/8	1/2	3.2
SH36-8M50F	1AF	SH	36	3.609	3.555	315/16	—	213/16	—	11/8	11/4	23/8	1/2	3.8
SH38-8M50F	1AF	SH	38	3.810	3.756	43/16	—	3	—	11/8	11/4	23/8	1/2	4.2
SH40--8M50F	1AF	SH	40	4.010	3.956	45/16	—	3	—	11/8	11/4	23/8	1/2	4.6
SD44-8M50F	1AF	SD	44	4.411	4.357	43/4	—	31/2	—	9/16	113/16	23/8	9/16	5.2
SD48-8M50F	1AF	SD	48	4.812	4.758	53/16	—	313/16	—	9/16	113/16	23/8	9/16	6.0
SK56-8M50F	1DF	SK	56	5.614	5.560	515/16	—	49/16	1/16	9/16	17/8	23/8	9/16	7.0
SK64-8M50F	1DF	SK	64	6.416	6.362	63/4	—	53/8	1/16	9/16	17/8	23/8	9/16	10.3
SK72-8M50F	1DF	SK	72	7.218	7.164	79/16	—	63/16	1/16	9/16	17/8	23/8	9/16	13.3
SF80-8M50F	1DF	SF	80	8.020	7.966	85/16	—	67/8	1/16	7/16	2	23/8	9/16	15.7
SF90-8M50	2D	SF	90	9.023	8.969	—	5	75/8	1/16	7/16	2	23/8	9/16	16.0
SF112-8M50	3D	SF	112	11.229	11.175	—	5	97/8	1/16	7/16	2	23/8	9/16	21.0
E144-8M50	3D	E	144	14.437	14.383	—	61/4	127/8	1/2	2	25/8	23/8	3/8	35.0
E192-8M50	3D	E	192	19.249	19.195	—	61/4	175/8	1/2	2	25/8	23/8	3/8	45.0

**Bore Range**

QTL BUSHINGS	Bore	
	Min	Max
JA	1/2	11/4
SH	1/2	15/16
SD	1/2	2
SK	1/2	25/8
SF	1/2	215/16
E	7/8	31/2

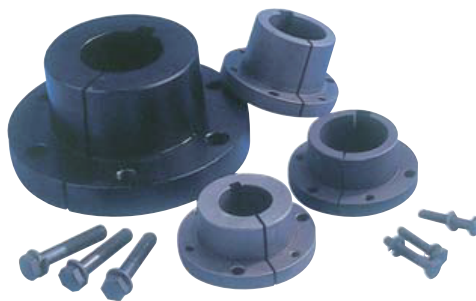

**Standard Keyseats**

Bore Range	Keyseat
15/16"-11/4"	1/4"x1/8"
15/16"-13/8	5/16x5/32
17/16"-13/4	3/8x3/16
113/16"-21/4	1/2x1/4
25/16"-23/4	5/8x5/16
213/16"-31/4	3/4x3/8
33/8"-33/4	7/8x7/16

1 3/8" Bore Bushings also available with 3/8"x3/16" Keyseat.

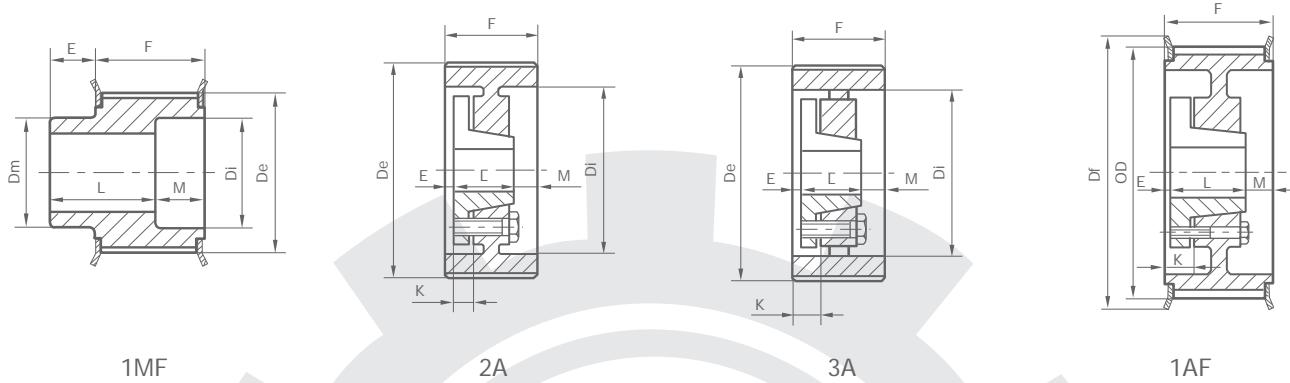

**HTP 8M-85**

SPCFCTN	TYPE	BUSH	Z	Diameter					Dimension					wt (lbs)
				Dp	De	Df	Dm	Di	E	M	L	F	K	
34-8M85F	1MF	—	34	3.409	3.355	39/16	251/64	—	3/4	—	41/2	33/4	—	10.0
36-8M85F	1MF	—	36	3.609	3.555	313/16	3	—	3/4	—	41/2	33/4	—	11.3
38-8M85F	1MF	—	38	3.810	3.756	4	33/16	—	3/4	—	41/2	33/4	—	12.6
40-8M85F	1MF	—	40	4.010	3.956	43/32	313/32	—	3/4	—	41/2	33/4	—	14/9
44-8M85F	1MF	—	44	4.411	4.357	43/4	351/64	—	3/4	—	41/2	33/4	—	17.2
48-8M85F	1MF	—	48	4.812	4.758	5	43/16	—	3/4	—	41/2	33/4	—	20.6
56-8M85F	1MF	—	56	5.614	5.560	515/16	5	—	3/4	—	41/2	33/4	—	28.0
SH34-8M85F	1AF	SH	34	3.409	3.355	313/16	—	23/4	1	11/2	11/4	33/4	11/2	4.6
SH36-8M85F	1AF	SH	36	3.609	3.555	315/16	—	213/16	1	11/2	11/4	33/4	11/2	5.2
SH38-8M85F	1AF	SH	38	3.810	3.756	43/16	—	3	1	11/2	11/4	33/4	11/2	5.8
SD40-8M85F	1AF	SD	40	4.010	3.956	45/16	—	31/4	11/16	11/4	113/16	33/4	11/4	6.2
SD44-8M85F	1AF	SD	44	4.411	4.357	43/4	—	31/2	11/16	11/4	113/16	33/4	11/4	6.6
SD48-8M85F	1AF	SD	48	4.812	4.758	53/16	—	313/16	11/16	11/4	113/16	33/4	11/4	7.8
SK56-8M85F	1AF	SK	56	5.614	5.560	515/16	—	45/8	5/8	11/4	17/8	33/4	11/4	9.8
SK64-8M85F	1AF	SK	64	6.416	6.362	63/4	—	53/8	5/8	11/4	17/8	33/4	11/4	13.0
SF72-8M85F	1AF	SF	72	7.218	7.164	79/16	—	63/16	5/8	11/8	2	33/4	11/4	16.0
SF80-8M85F	1AF	SF	80	8.020	7.966	83/8	—	67/8	5/8	11/8	2	33/4	11/4	16.0
SF90-8M85	2A	SF	90	9.023	8.969	—	5	75/8	5/8	11/8	2	33/4	11/4	20.0
SF112-8M85	3A	SF	112	11.229	11.175	—	5	97/8	5/8	11/8	2	33/4	11/4	28.0
E144-8M85	3A	E	144	14.447	14.383	—	61/4	127/8	3/16	15/16	25/8	33/4	11/16	64.5
E192-8M85	3A	E	192	19.249	19.195	—	61/4	175/8	3/16	15/16	25/8	33/4	11/16	78.1

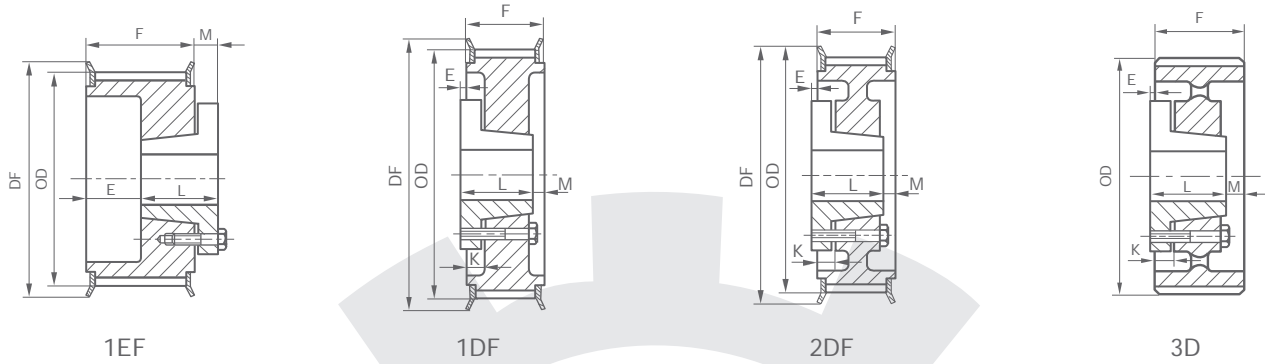

**HTP 14M-40**

SPCFCTN	TYPE	BUSH	Z	Diameter					Dimension					wt (lbs)
				Dp	De	Df	Dm	Di	E	M	L	F	K	
SK28-14M40F	1EF	SK	28	4.912	4.808	59/16	—	31/8	7/8	5/8	17/8	21/8	—	5.5
SK29-14M40F	1EF	SK	29	5.088	4.983	59/16	—	31/8	7/8	5/8	17/8	21/8	—	6.5
SK30-14M40F	1DF	SK	30	5.263	5.153	61/8	—	315/16	3/16	7/16	17/8	21/8	7/16	7.0
SK32-14M40F	1DF	SK	32	5.614	5.504	61/8	—	315/16	3/16	7/16	17/8	21/8	7/16	8.0
SK34-14M40F	1DF	SK	34	5.965	5.858	61/2	—	41/16	3/16	7/16	17/8	21/8	7/16	8.5
SF36-14M40F	1DF	SF	36	6.316	6.206	613/16	—	411/16	3/16	5/16	2	21/8	7/16	9.5
SF38-14M40F	1DF	SF	38	6.667	6.557	73/16	—	415/16	3/16	5/16	2	21/8	7/16	11.5
SF40-14M40F	1DF	SF	40	7.018	6.909	71/2	—	51/16	3/16	5/16	2	21/8	7/16	13.0
E44-14M40F	1DF	E	44	7.720	7.610	87/32	—	61/8	5/8	1/8	25/8	21/8	1/4	16.5
E48-14M40F	1DF	E	48	8.421	8.311	87/8	—	61/2	5/8	1/8	25/8	21/8	1/4	20.0
E52-14M40E	1DF	E	52	9.123	9.013	911/16	—	73/16	5/8	1/8	25/8	21/8	1/4	24.0
E56-14M40F	1DF	E	56	9.825	9.715	103/8	—	77/8	5/8	7/8	25/8	21/8	1/4	28.0
E60-14M40F	1DF	E	60	10.527	10.417	111/16	—	81/2	5/8	1/8	25/8	21/8	1/4	29.0
E64-14M40F	2DF	E	64	11.229	11.119	113/4	61/4	91/4	5/8	1/8	25/8	21/8	1/4	31.0
E68-14M40F	2DF	E	68	11.930	11.820	121/2	61/4	10	5/8	1/8	25/8	21/8	1/4	32.0
E72-14M40F	2DF	E	72	12.632	12.522	133/16	61/4	1011/16	5/8	1/8	25/8	21/8	1/4	33.0
E80-14M40F	2DF	E	80	14.036	13.926	145/8	61/4	121/8	5/8	1/8	25/8	21/8	1/4	38.0
E90-14M40	3D	E	90	15.790	15.680	—	61/4	14	5/8	1/8	25/8	21/8	1/4	39.0
E112-14M40	3D	E	112	19.650	19.540	—	61/4	1713/16	5/8	1/8	25/8	21/8	1/4	51.0
E144-14M40	3D	E	144	25.264	25.154	—	61/4	233/8	5/8	1/8	25/8	21/8	1/4	80.0

**T<sub>aper</sub>  
B<sub>ore</sub>** **HTP** *Timing pulley*



**QTL**

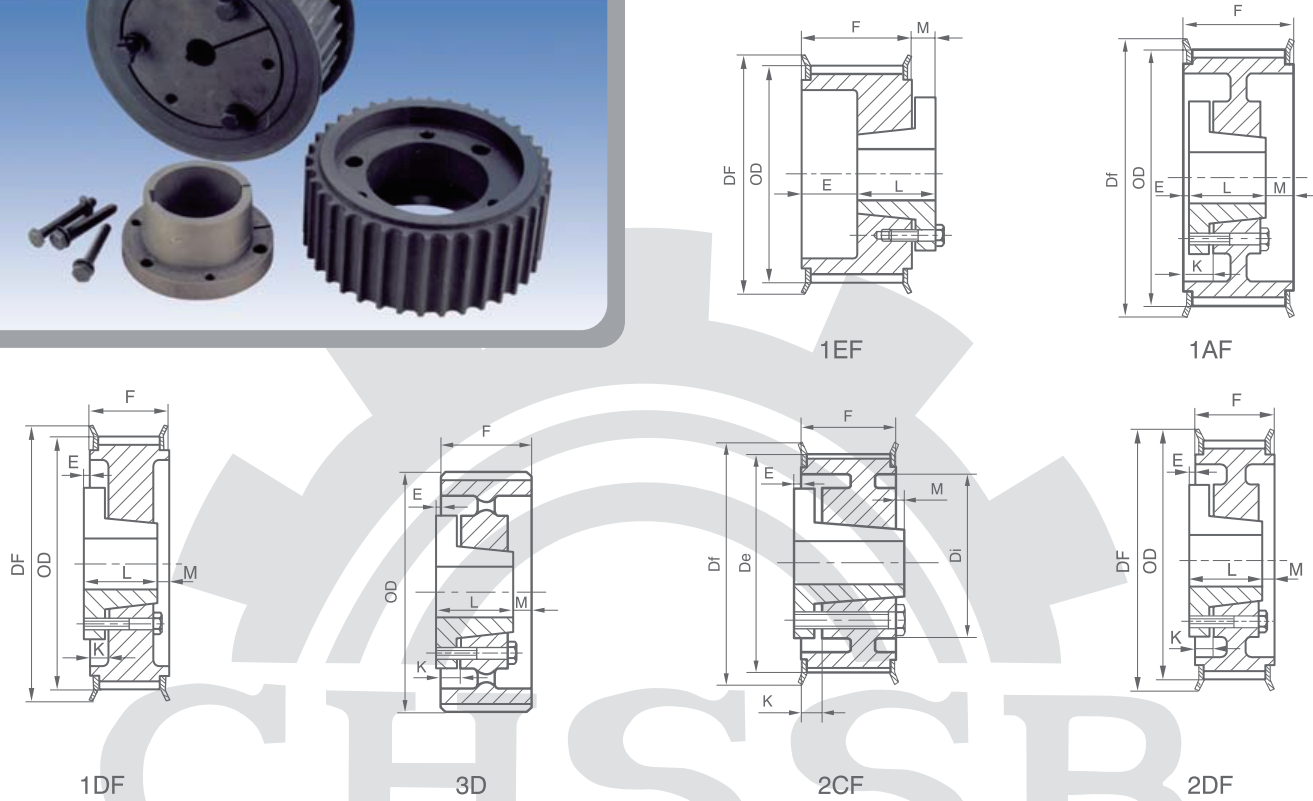

**HTP 14M-55**

SPCFCTN	TYPE	BUSH	Z	Diameter					Dimension					wt (lbs)
				Dp	De	Df	Dm	Di	E	M	L	F	K	
SK28-14M55F	1EF	SK	28	4.912	4.808	59/16	—	31/8	11/2	5/8	17/8	23/4	—	1.0
SK29-14M55F	1EF	SK	29	5.088	4.983	59/16	—	31/8	11/2	5/8	17/8	23/4	—	8.0
SK30-14M55F	1AF	SK	30	5.263	5.157	61/8	—	315/16	1/8	3/4	17/8	23/4	3/4	8.5
SK32-14M55F	1AF	SK	32	5.614	5.507	61/8	—	315/16	1/8	3/4	17/8	23/4	3/4	9.0
SK34-14M55F	1AF	SK	34	5.965	5.858	61/2	—	41/16	1/8	3/4	17/8	23/4	3/4	10.0
SF36-14M55F	1AF	SF	36	6.316	6.208	613/16	—	411/16	1/8	5/8	2	23/4	3/4	11.0
SF38-14M55F	1AF	SF	38	6.667	6.559	73/16	—	415/16	1/8	5/8	2	23/4	3/4	13.0
SF40-14M55F	1AF	SF	40	7.018	6.909	71/2	—	51/16	1/8	5/8	2	23/4	3/4	15.0
E44-14M55F	1DF	E	44	7.720	7.610	87/32	—	61/8	5/16	7/16	25/8	23/4	9/16	19.0
E48-14M55F	1DF	E	48	8.421	8.311	815/16	—	61/2	5/16	7/16	25/8	23/4	9/16	23.0
E52-14M55F	1DF	E	52	9.123	9.013	911/16	—	73/16	5/16	7/16	25/8	23/4	9/16	27.0
E56-14M55F	1DF	E	56	9.825	9.715	103/8	—	77/8	5/16	7/16	25/8	23/4	9/16	32.0
E60-14M55F	1DF	E	60	10.527	10.417	111/16	—	81/2	5/16	7/16	25/8	23/4	9/16	36.0
F64-14M55F	1CF	F	64	11.229	11.119	113/4	—	91/4	7/8	—	35/8	23/4	1/8	53.0
F68-14M55F	2DF	F	68	11.930	11.820	121/2	—	10	7/8	—	35/8	23/4	1/8	43.0
F72-14M55F	2CF	F	72	12.632	12.522	133/16	7	1011/16	7/8	—	35/8	23/4	1/8	49.0
F80-14M55F	2CF	F	80	14.036	13.926	145/8	7	121/8	7/8	—	35/8	23/4	1/8	54.0
F90-14M55	3D	F	90	15.790	15.680	—	7	14	7/8	—	35/8	23/4	1/8	55.0
F112-14M55	3D	F	112	19.650	19.540	—	7	177/8	7/8	—	35/8	23/4	1/8	71.0
F144-14M55	3D	F	144	25.264	25.154	—	7	233/8	7/8	—	35/8	23/4	1/8	106.0
F168-14M55	3D	F	168	29.475	29.365	—	7	279/16	7/8	—	35/8	23/4	1/8	124.0
F192-14M55	3D	F	192	33.686	33.576	—	7	3113/16	7/8	—	35/8	23/4	1/8	146.0
F216-14M55	3D	F	216	37.896	37.786	—	7	353/4	7/8	—	35/8	23/4	1/8	205.0

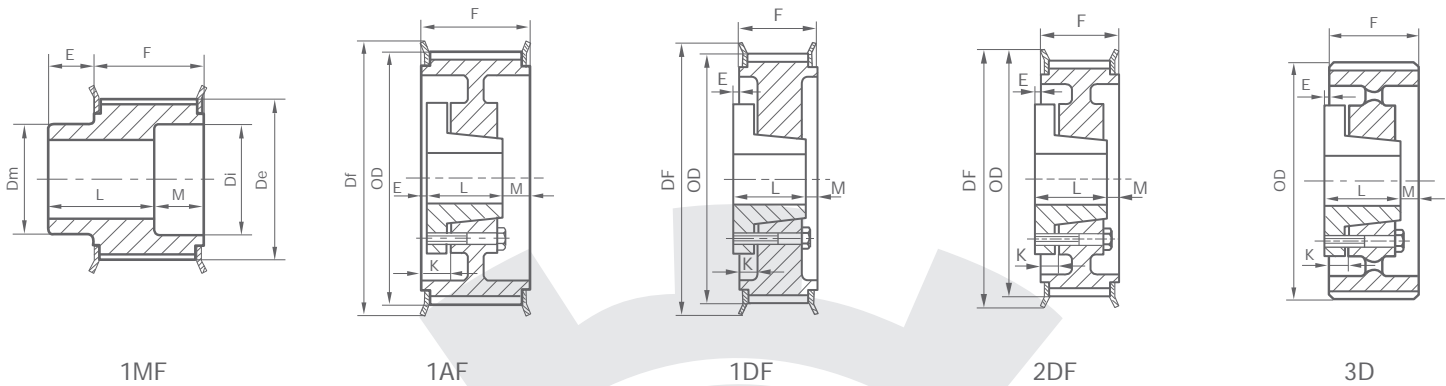

**HTP 14M-85**

SPCFCTN	TYPE	BUSH	Z	Diameter					Dimension					wt (lbs)
				Dp	De	Df	Dm	Di	R	M	L	F	K	
28-14M85F	1MF	—	28	4.912	4.808	59/16	311/4	31/8	1	1	4	4	—	18.0
29-14M85F	1MF	—	29	5.088	4.983	59/16	311/16	31/8	1	1	4	4	—	19.4
30-14M85F	1MF	—	30	5.263	5.157	61/8	49/14	329/32	1	1	4	4	—	20.0
32-14M85F	1MF	—	32	5.614	5.507	61/8	49/64	329/32	1	1	4	4	—	23.4
SK30-14M85F	1AF	SK	30	5.293	5.157	61/8	—	315/16	3/4	13/8	17/8	4	13/8	10
SK32-14M85F	1AF	SK	32	5.614	5.507	61/8	—	315/16	3/4	13/8	17/8	4	13/8	13
SK34-14M85F	1AF	SK	34	5.965	5.858	61/2	—	41/16	3/4	13/8	17/8	4	13/8	14
SF36-14M85F	1AF	SF	36	6.316	6.206	613/16	—	411/16	3/4	11/4	2	4	13/8	15
SF38-14M85F	1AF	SF	38	6.667	6.557	73/16	—	415/16	3/4	11/4	2	4	13/8	18
SF40-14M85F	1AF	SF	40	7.018	6.909	71/2	—	51/16	3/4	11/4	2	4	13/8	20
E44-14M85F	1AF	E	44	7.720	7.610	87/32	—	61/8	5/16	11/16	25/8	4	13/16	25
E48-14M85F	1AF	E	48	8.421	8.311	815/16	—	61/2	5/16	11/16	25/8	4	13/16	29
E52-14M85F	1AF	E	52	9.123	9.103	911/16	—	73/6	5/16	11/16	25/8	4	13/16	32
F56-14M85F	1DF	F	56	9.825	9.715	103/8	—	77/8	1/4	5/8	35/8	4	3/4	46
F60-14M85F	1DF	F	60	10.527	10.417	111/16	—	81/2	1/4	5/8	35/8	4	3/4	51
F64-14M85F	1DF	F	64	11.229	11.119	113/4	—	91/4	1/4	5/8	35/8	4	3/4	62
F68-14M85F	2DF	F	68	11.930	11.820	121/2	7	10	1/4	5/8	35/8	4	3/4	51
F72-14M85F	2DF	F	72	12.632	12.522	133/16	7	1011/16	1/4	5/8	35/8	4	3/4	60
F80-14M85F	2DF	F	80	14.036	13.926	145/8	7	121/8	1/4	5/8	35/8	4	3/4	66
F90-14M85	3D	F	90	15.790	15.680	—	7	14	1/4	5/8	35/8	4	3/4	69
F112-14M85	3D	F	112	19.650	19.540	—	7	177/8	1/4	5/8	35/8	4	3/4	89
F144-14M85	3D	F	144	25.264	25.154	—	7	233/8	1/4	5/8	35/8	4	3/4	127
F168-14M85	3D	F	168	29.475	29.365	—	7	279/16	1/4	5/8	35/8	4	3/4	148
F192-14M85	3D	F	192	33.686	33.576	—	7	3113/16	1/4	5/8	35/8	4	3/4	177
F216-14M85	3D	F	216	37.896	37.786	—	7	353/4	1/4	5/8	35/8	4	3/4	25



**T<sub>aper</sub>  
B<sub>ore</sub>** HTP *Timing pulley*



**QTL**

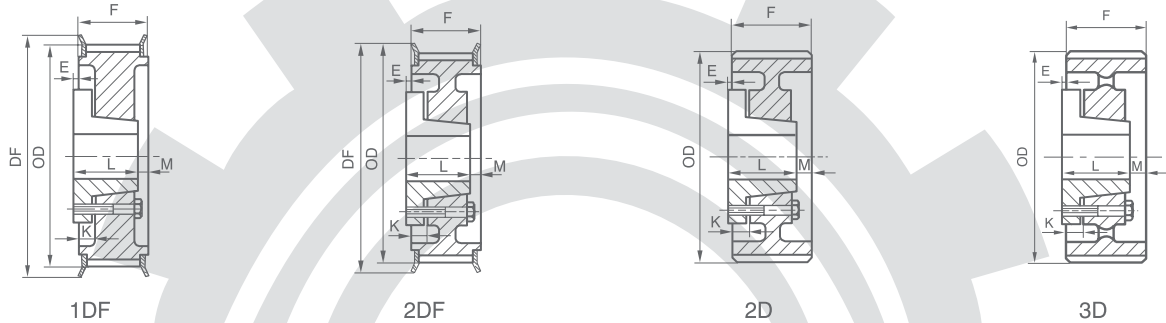
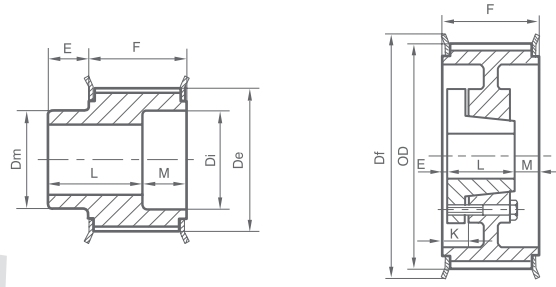

**HTP 14M-115**

SPCFCTN	TYPE	BUSH	Z	Diameter					Dimension					wt (lbs)
				Dp	De	Df	Dm	Di	E	M	L	F	K	
28-14M115F	1MF	—	28	4.912	4.808	59/16	311/16	31/8	11/4	11/2	5	51/4	—	23.2
29-14M115F	1MF	—	29	5.088	4.983	59/16	311/16	31/8	11/4	11/2	5	51/4	—	24.8
30-14M115F	1MF	—	30	5.263	5.157	61/8	49/64	320/32	11/4	11/2	5	51/4	—	264
32-14M115F	1MF	—	32	5.614	5.567	61/8	49/64	329/32	11/4	11/2	5	51/4	—	30.8
34-14M115F	1MF	—	34	5.965	5.858	61/2	431/64	41/16	11/4	11/2	5	51/4	—	35.2
36-14M115F	1MF	—	36	6.316	6.208	613/16	47/8	411/16	11/4	11/2	5	51/4	—	38.8
38-14M115F	1MF	—	38	6.667	6.559	73/16	511/64	415/16	11/4	11/2	5	51/4	—	44.4
40-14M115F	1MF	—	40	7.018	6.909	71/2	59/16	51/16	11/4	11/2	5	51/4	—	50
SK30-14M115F	1AF	SK	30	5.263	5.157	61/8	—	315/16	13/8	2	17/8	51/4	2	12
SK32-14M115F	1AF	SK	32	5.614	5.507	61/8	—	315/16	13/8	2	17/8	51/4	2	16
SK34-14M115F	1AF	SK	34	5.965	5.858	61/2	—	41/16	13/8	2	17/8	51/4	2	17
SF36-14M115F	1AF	SF	36	6.316	6.208	613/16	—	411/16	13/8	17/8	2	51/4	2	18
SF38-14M115F	1AF	SF	38	6.667	6.559	73/16	—	415/16	13/8	17/8	2	51/4	2	22
SF40-14M115F	1AF	SF	40	7.018	6.909	71/2	—	51/16	13/8	17/8	2	51/4	2	25
E44-14M115F	1AF	E	44	7.720	7.610	87/32	—	61/8	15/16	111/16	25/8	51/4	113/16	30
E48-14M115F	1AF	E	48	8.421	8.311	815/16	—	61/2	15/16	111/16	25/8	51/4	113/16	35
F52-14M115F	1AF	F	52	9.123	9.013	911/16	—	73/16	3/8	11/4	35/8	51/4	13/8	42
F56-14M115F	1AF	F	56	9.825	9.715	103/8	—	77/8	3/8	11/4	35/8	51/4	13/8	53
F60-14M115F	1AF	F	60	10.527	10.417	111/16	—	81/2	3/8	11/4	35/8	51/4	13/8	60
J64-14M115F	1DF	J	64	11.229	11.119	113/4	—	91/4	3/16	15/16	41/2	51/4	1	76
J68-14M115F	1DF	J	68	11.930	11.820	121/2	—	10	3/16	15/16	41/2	51/4	1	83
J72-14M115F	1DF	J	72	12.632	12.522	133/16	—	1011/16	3/16	15/16	41/2	51/4	1	99
J80-14M115F	2DF	J	80	14.036	13.926	145/8	73/4	121/8	3/16	15/16	41/2	51/4	1	87
J90-14M115	2D	J	90	15.790	15.680	—	73/4	14	3/16	15/16	41/2	51/4	1	95
J112-14M115	3D	J	112	19.650	19.540	—	73/4	177/8	3/16	15/16	41/2	51/4	1	114
J144-14M115	3D	J	144	25.264	25.154	—	73/4	233/8	3/16	15/16	41/2	51/4	1	166
J168-14M115	3D	J	168	29.475	29.365	—	73/4	279/16	3/16	15/16	41/2	51/4	1	198
J192-14M115	3D	J	192	33.686	33.576	—	73/4	3113/16	3/16	15/16	41/2	51/4	1	232
J216-14M115	3D	J	216	37.896	37.786	—	73/4	353/4	3/16	15/16	41/2	51/4	1	307

**T<sub>B</sub>** <sup>aper</sup> <sub>ore</sub> **HTP** *Timing pulley*

**QTL**

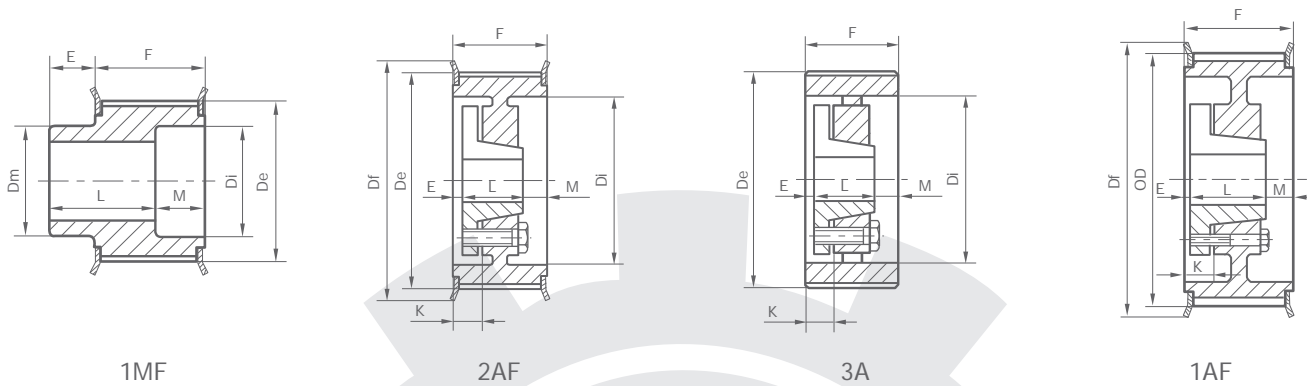

**HTP 14M-170**

SPCFCTN	TYPE	BUSH	Z	Diameter					Dimension					wt (lbs)
				Dp	De	Df	Dm	Di	E	M	L	F	K	
36-14M170F	1MF	—	36	6.316	6.208	6 <sup>13</sup> / <sub>16</sub>	4 <sup>7</sup> / <sub>8</sub>	4 <sup>11</sup> / <sub>16</sub>	1 <sup>1</sup> / <sub>4</sub>	2 <sup>5</sup> / <sub>8</sub>	6	7 <sup>3</sup> / <sub>8</sub>	—	47
38-14M170F	1MF	—	38	6.667	6.559	7 <sup>3</sup> / <sub>16</sub>	5 <sup>11</sup> / <sub>64</sub>	4 <sup>15</sup> / <sub>16</sub>	1 <sup>1</sup> / <sub>4</sub>	2 <sup>5</sup> / <sub>8</sub>	6	7 <sup>3</sup> / <sub>8</sub>	—	55.7
40-14M170F	1MF	—	40	7.018	6.909	7 <sup>1</sup> / <sub>2</sub>	5 <sup>9</sup> / <sub>16</sub>	5 <sup>1</sup> / <sub>16</sub>	1 <sup>1</sup> / <sub>4</sub>	2 <sup>5</sup> / <sub>8</sub>	6	7 <sup>3</sup> / <sub>8</sub>	—	63.7
44-14M170F	1MF	—	44	7.720	7.610	8 <sup>7</sup> / <sub>32</sub>	6 <sup>41</sup> / <sub>64</sub>	6 <sup>1</sup> / <sub>8</sub>	1 <sup>1</sup> / <sub>4</sub>	2 <sup>5</sup> / <sub>8</sub>	6	7 <sup>3</sup> / <sub>8</sub>	—	75.7
48-14M170F	1MF	—	48	8.421	8.311	8 <sup>15</sup> / <sub>16</sub>	6 <sup>15</sup> / <sub>16</sub>	6 <sup>1</sup> / <sub>2</sub>	1 <sup>1</sup> / <sub>4</sub>	2 <sup>5</sup> / <sub>8</sub>	6	7 <sup>3</sup> / <sub>8</sub>	—	94
E44-14M170F	1AF	E	44	7.720	7.610	8 <sup>7</sup> / <sub>32</sub>	—	6 <sup>1</sup> / <sub>8</sub>	2	2 <sup>3</sup> / <sub>4</sub>	2 <sup>5</sup> / <sub>8</sub>	7 <sup>3</sup> / <sub>8</sub>	2 <sup>7</sup> / <sub>8</sub>	38
E48-14M170F	1AF	E	48	8.421	8.311	8 <sup>15</sup> / <sub>16</sub>	—	6 <sup>1</sup> / <sub>2</sub>	2	2 <sup>3</sup> / <sub>4</sub>	2 <sup>5</sup> / <sub>8</sub>	7 <sup>3</sup> / <sub>8</sub>	2 <sup>7</sup> / <sub>16</sub>	45
F52-14M170F	1AF	F	52	9.123	9.013	9 <sup>11</sup> / <sub>16</sub>	—	7 <sup>3</sup> / <sub>16</sub>	1 <sup>7</sup> / <sub>16</sub>	2 <sup>5</sup> / <sub>16</sub>	3 <sup>5</sup> / <sub>8</sub>	7 <sup>3</sup> / <sub>8</sub>	2 <sup>7</sup> / <sub>16</sub>	52
F56-14M170F	1AF	F	56	9.825	9.715	10 <sup>3</sup> / <sub>8</sub>	—	7 <sup>7</sup> / <sub>8</sub>	1 <sup>7</sup> / <sub>16</sub>	2 <sup>5</sup> / <sub>16</sub>	3 <sup>5</sup> / <sub>8</sub>	7 <sup>3</sup> / <sub>8</sub>	2 <sup>1</sup> / <sub>8</sub>	65
J60-14M170F	1AF	J	60	10.527	10.417	11 <sup>1</sup> / <sub>16</sub>	—	8 <sup>1</sup> / <sub>2</sub>	1 <sup>5</sup> / <sub>16</sub>	1 <sup>15</sup> / <sub>16</sub>	4 <sup>1</sup> / <sub>2</sub>	7 <sup>3</sup> / <sub>8</sub>	2 <sup>1</sup> / <sub>8</sub>	75
J64-14M170F	1AF	J	64	11.229	11.119	11 <sup>3</sup> / <sub>4</sub>	—	9 <sup>1</sup> / <sub>4</sub>	1 <sup>5</sup> / <sub>16</sub>	1 <sup>15</sup> / <sub>16</sub>	4 <sup>1</sup> / <sub>2</sub>	7 <sup>3</sup> / <sub>8</sub>	2 <sup>1</sup> / <sub>8</sub>	91
J68-14M170F	1AF	J	68	11.930	11.820	11 <sup>2</sup> / <sub>1</sub>	—	10	1 <sup>5</sup> / <sub>16</sub>	1 <sup>15</sup> / <sub>16</sub>	4 <sup>1</sup> / <sub>2</sub>	7 <sup>3</sup> / <sub>8</sub>	2 <sup>1</sup> / <sub>8</sub>	96
J72-14M170F	1AF	J	72	12.632	12.522	13 <sup>3</sup> / <sub>16</sub>	—	10 <sup>11</sup> / <sub>16</sub>	1 <sup>5</sup> / <sub>16</sub>	1 <sup>15</sup> / <sub>16</sub>	4 <sup>1</sup> / <sub>2</sub>	7 <sup>3</sup> / <sub>8</sub>	2 <sup>1</sup> / <sub>8</sub>	115
J80-14M170F	2AF	J	80	14.036	13.926	14 <sup>5</sup> / <sub>8</sub>	7 <sup>3</sup> / <sub>4</sub>	12 <sup>1</sup> / <sub>8</sub>	1 <sup>5</sup> / <sub>16</sub>	1 <sup>15</sup> / <sub>16</sub>	4 <sup>1</sup> / <sub>2</sub>	7 <sup>3</sup> / <sub>8</sub>	2 <sup>1</sup> / <sub>8</sub>	117
J90-14M170	2A	J	90	15.790	15.680	—	7 <sup>3</sup> / <sub>4</sub>	14	1 <sup>5</sup> / <sub>16</sub>	1 <sup>15</sup> / <sub>16</sub>	4 <sup>1</sup> / <sub>2</sub>	7 <sup>3</sup> / <sub>8</sub>	2 <sup>1</sup> / <sub>8</sub>	126
M112-14M170	3A	M	112	19.650	19.540	—	9 <sup>1</sup> / <sub>2</sub>	17 <sup>7</sup> / <sub>8</sub>	—	5 <sup>8</sup> / <sub>8</sub>	6 <sup>3</sup> / <sub>4</sub>	7 <sup>3</sup> / <sub>8</sub>	1 <sup>7</sup> / <sub>16</sub>	175
M144-14M170	3A	M	144	25.264	25.154	—	9 <sup>1</sup> / <sub>2</sub>	23 <sup>3</sup> / <sub>8</sub>	—	5 <sup>8</sup> / <sub>8</sub>	6 <sup>3</sup> / <sub>4</sub>	7 <sup>3</sup> / <sub>8</sub>	1 <sup>7</sup> / <sub>16</sub>	240
M168-14M170	3A	M	168	29.475	29.365	—	9 <sup>1</sup> / <sub>2</sub>	27 <sup>9</sup> / <sub>16</sub>	—	2 <sup>8</sup> / <sub>5</sub>	3 <sup>3</sup> / <sub>4</sub>	7 <sup>3</sup> / <sub>8</sub>	1 <sup>7</sup> / <sub>16</sub>	278
M192-14M170	3A	M	192	33.686	33.576	—	9 <sup>1</sup> / <sub>2</sub>	31 <sup>13</sup> / <sub>16</sub>	—	5 <sup>8</sup> / <sub>8</sub>	6 <sup>3</sup> / <sub>4</sub>	7 <sup>3</sup> / <sub>8</sub>	1 <sup>7</sup> / <sub>16</sub>	322
M216-14M170	3A	M	216	37.896	37.786	—	9 <sup>1</sup> / <sub>2</sub>	35 <sup>3</sup> / <sub>4</sub>	—	5 <sup>8</sup> / <sub>8</sub>	6 <sup>3</sup> / <sub>4</sub>	7 <sup>3</sup> / <sub>8</sub>	1 <sup>7</sup> / <sub>16</sub>	39

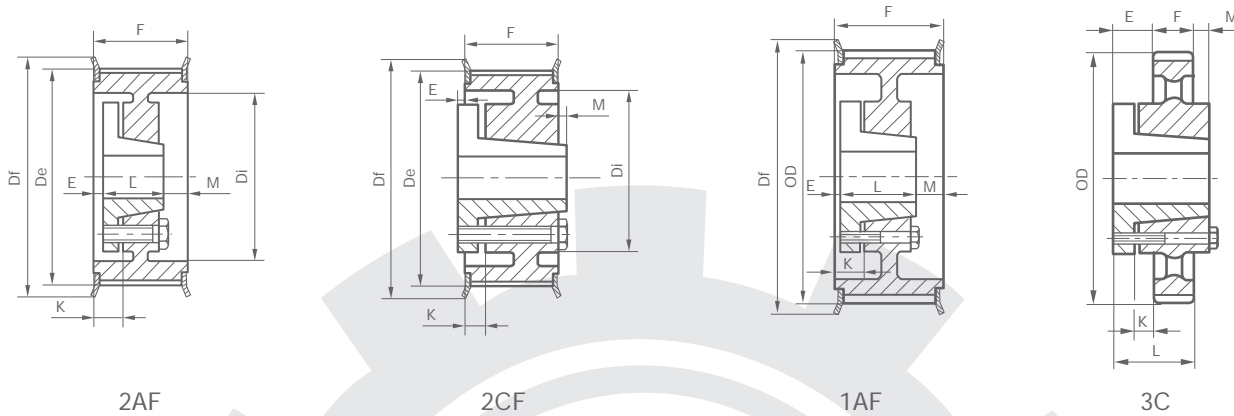

**HTP 20M-115**

SPCFCTN	TYPE	BUSH	Z	Diameter					Dimension					wt (lbs)
				Dp	De	Df	Dm	Di	E	M	L	F	K	
F34-20M115F	1AF	F	34	8.522	8.352	97/16	—	67/8	7/16	15/16	35/8	53/8	17/16	32
F36-20M115F	1AF	F	36	9.023	8.853	97/8	—	7	7/16	15/16	35/8	53/8	17/16	40
F38-20M115F	1AF	F	38	9.524	9.354	107/16	—	79/16	7/16	15/16	35/8	53/8	17/16	45
F40-20M115F	1AF	F	40	10.026	9.856	1013/16	—	8	7/16	15/16	35/8	53/8	17/16	51
F44-20M115F	1AF	F	44	11.028	10.858	1113/16	—	815/16	7/16	15/16	35/8	53/8	17/16	63
J48-20M115F	1AF	J	48	12.031	11.861	1213/16	—	915/16	—	7/8	41/2	53/8	13/16	84
J52-20M115F	2AF	J	52	13.033	12.863	133/4	73/4	107/8	—	7/8	41/2	53/8	13/16	90
J56-20M115F	2AF	J	56	14.036	13.866	143/4	73/4	117/8	—	7/8	41/2	53/8	13/16	94
J60-20M115F	2AF	J	60	15.038	14.868	1515/16	73/4	131/16	—	7/8	41/2	53/8	13/16	97
J64-20M115F	2AF	J	64	16.041	15.871	1615/16	73/4	141/16	—	7/8	41/2	53/8	13/16	104
J68-20M115F	2AF	J	68	17.044	16.874	1715/16	73/4	15	—	7/8	41/2	53/8	13/16	110
J72-20M115F	2AF	J	72	18.046	17.876	187/8	73/4	16	—	7/8	41/2	53/8	13/16	119
M80-20M115F	2CF	M	80	20.051	19.881	207/8	91/2	18	11/4	1/8	63/4	53/8	3/16	182
M90-20M115F	2CF	M	90	22.558	22.388	237/16	91/2	209/16	11/4	1/8	63/4	53/8	3/16	212
M112-20M115	3C	M	112	28.072	27.902	—	91/2	263/8	11/4	1/8	63/4	53/8	3/16	239
N144-20M115	3C	N	144	36.092	35.922	—	101/2	343/8	13/4	1	81/8	53/8	—	341
N168-20M115	3C	N	168	42.108	41.938	—	101/2	403/8	13/4	1	81/8	53/8	—	417
N192-20M115	3C	N	192	48.123	47.953	—	101/2	461/4	13/4	1	81/8	53/8	—	550
N216-20M115	3C	N	216	54.138	53.968	—	101/2	521/4	13/4	1	81/8	53/8	—	566

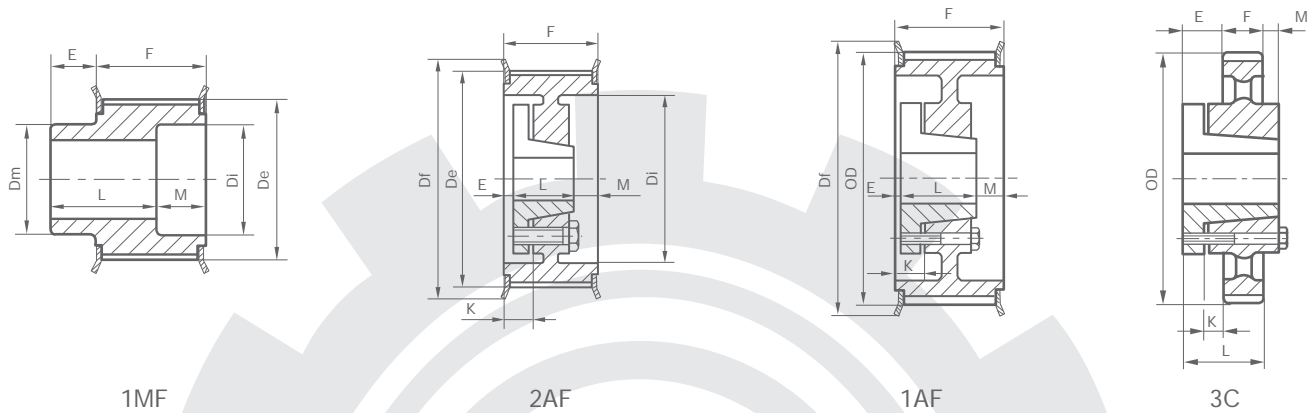

**HTP 20M-170**

SPCFCTN	TYPE	BUSH	Z	Diameter					Dimension					wt (lbs)
				Dp	De	Df	Dm	Di	E	M	L	F	K	
34-20M170F	1MF	—	34	8.522	8.352	97/16	61/2	61/2	11/4	21/4	61/2	71/2	—	82
36-20M170F	1MF	—	36	9.023	8.853	97/8	7	7	11/4	21/4	61/2	71/2	—	92
J38-20M170F	1AF	J	38	9.524	9.354	107/16	—	79/16	1	2	41/2	71/2	23/16	56
J40-20M170F	1AF	J	40	10.026	9.856	1013/16	—	8	1	2	41/2	71/2	23/16	64
J44-20M170F	1AF	J	44	11.028	10.858	1113/16	—	815/16	1	2	41/2	71/2	23/16	81
M48-20M170F	1AF	M	48	12.031	11.861	1213/16	—	915/16	1/16	11/16	63/4	71/2	11/2	113
M52-20M170F	1AF	M	53	13.033	12.863	133/4	—	107/8	1/16	11/16	63/4	71/2	11/2	141
M56-20M170F	1AF	M	56	14.036	13.866	143/4	—	117/8	1/16	11/16	63/4	71/2	11/2	170
M60-20M170F	1AF	M	60	15.038	14.868	1415/16	—	131/16	1/16	11/16	63/4	71/2	11/2	199
M64-20M170F	2AF	M	64	16.041	15.871	1615/16	91/2	141/16	1/16	11/16	63/4	71/2	11/2	175
M68-20M170F	2AF	M	68	17.044	16.874	1715/16	91/2	15	1/16	11/16	63/4	71/2	11/2	187
M72-20M170F	2AF	M	72	18.046	17.876	187/8	91/2	16	1/16	11/16	63/4	71/2	11/2	176
M80-20M170F	2AF	M	80	20.051	19.881	207/8	91/2	18	1/16	11/16	63/4	71/2	11/2	214
M90-20M170F	2AF	M	90	22.558	22.388	237/16	91/2	209/16	1/16	11/16	63/4	71/2	11/2	250
N112-20M170	3C	N	112	28.072	27.902	—	101/2	261/4	1/2	1/8	81/8	71/2	11/4	309
N144-20M170	3C	N	144	36.092	35.922	—	101/2	341/4	1/2	1/8	81/8	71/2	11/4	426
P168-20M170	3C	P	168	42.108	41.938	—	13	401/4	15/16	15/16	93/8	71/2	11/16	571
P192-20M170	3C	P	192	48.123	47.953	—	13	461/4	15/16	15/16	93/8	71/2	11/16	652
P216-20M170	3C	P	216	54.138	53.968	—	13	521/8	15/16	15/16	93/8	71/2	11/16	813

**T<sub>aper</sub>  
B<sub>ore</sub>** **HTP** *Timing pulley*



**QTL**

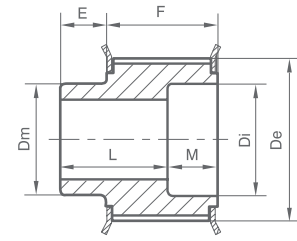

1MF

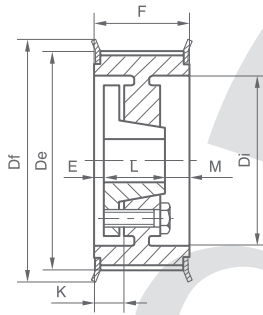

2AF

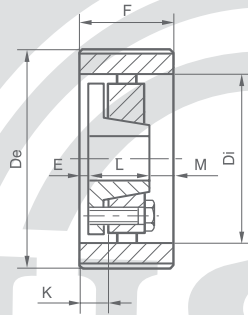

3A

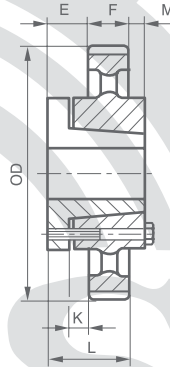

3C

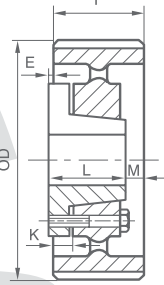

3D

**HTP 20M-230**

SPCFCTN	TYPE	BUSH	Z	Diameter					Dimension					wt (lbs)
				Dp	De	Df	Dm	Di	E	M	L	F	K	
-20M230F	1MF	—	38	9.524	9.354	10 <sup>7</sup> / <sub>16</sub>	7 <sup>1</sup> / <sub>2</sub>	7 <sup>9</sup> / <sub>16</sub>	1 <sup>1</sup> / <sub>4</sub>	3 <sup>5</sup> / <sub>8</sub>	7 <sup>1</sup> / <sub>2</sub>	9 <sup>7</sup> / <sub>8</sub>	—	120
-20M230F	1MF	—	40	10.026	9.856	10 <sup>13</sup> / <sub>16</sub>	8	8	1 <sup>1</sup> / <sub>4</sub>	2 <sup>5</sup> / <sub>8</sub>	8 <sup>1</sup> / <sub>2</sub>	9 <sup>7</sup> / <sub>8</sub>	—	147
-20M230F	1MF	—	44	11.028	10.858	11 <sup>13</sup> / <sub>16</sub>	8 <sup>1</sup> / <sub>4</sub>	8 <sup>15</sup> / <sub>16</sub>	1 <sup>1</sup> / <sub>4</sub>	2 <sup>5</sup> / <sub>8</sub>	8 <sup>1</sup> / <sub>2</sub>	9 <sup>7</sup> / <sub>8</sub>	—	180
48-20M230F	1AF	M	48	12.031	11.861	12 <sup>13</sup> / <sub>16</sub>	—	9 <sup>15</sup> / <sub>16</sub>	9 <sup>1</sup> / <sub>16</sub>	2 <sup>9</sup> / <sub>16</sub>	6 <sup>3</sup> / <sub>4</sub>	9 <sup>7</sup> / <sub>8</sub>	2	129
52-20M230F	1AF	M	52	13.033	12.863	13 <sup>3</sup> / <sub>4</sub>	—	10 <sup>7</sup> / <sub>8</sub>	9 <sup>1</sup> / <sub>16</sub>	2 <sup>9</sup> / <sub>16</sub>	6 <sup>3</sup> / <sub>4</sub>	9 <sup>7</sup> / <sub>8</sub>	2	158
56-20M230F	1AF	M	56	14.036	13.866	14 <sup>3</sup> / <sub>4</sub>	—	11 <sup>7</sup> / <sub>8</sub>	9 <sup>1</sup> / <sub>16</sub>	2 <sup>9</sup> / <sub>16</sub>	6 <sup>3</sup> / <sub>4</sub>	9 <sup>7</sup> / <sub>8</sub>	2	189
60-20M230F	1AF	M	60	15.038	14.868	15 <sup>15</sup> / <sub>16</sub>	—	13 <sup>1</sup> / <sub>16</sub>	9 <sup>1</sup> / <sub>16</sub>	2 <sup>9</sup> / <sub>16</sub>	6 <sup>3</sup> / <sub>4</sub>	9 <sup>7</sup> / <sub>8</sub>	2	298
64-20M230F	2AF	M	64	16.041	15.871	16 <sup>15</sup> / <sub>16</sub>	9 <sup>1</sup> / <sub>2</sub>	14 <sup>1</sup> / <sub>6</sub>	9 <sup>1</sup> / <sub>16</sub>	2 <sup>9</sup> / <sub>16</sub>	6 <sup>3</sup> / <sub>4</sub>	9 <sup>7</sup> / <sub>8</sub>	2	2978
68-20M230F	1AF	N	68	17.044	16.874	14 <sup>15</sup> / <sub>16</sub>	10 <sup>1</sup> / <sub>2</sub>	15	1 <sup>1</sup> / <sub>16</sub>	11 <sup>1</sup> / <sub>16</sub>	8 <sup>1</sup> / <sub>8</sub>	9 <sup>7</sup> / <sub>8</sub>	1 <sup>13</sup> / <sub>16</sub>	324
72-20M230F	2AF	N	72	18.046	17.876	18 <sup>7</sup> / <sub>8</sub>	10 <sup>1</sup> / <sub>2</sub>	16	1 <sup>1</sup> / <sub>16</sub>	11 <sup>1</sup> / <sub>16</sub>	8 <sup>1</sup> / <sub>8</sub>	9 <sup>7</sup> / <sub>8</sub>	1 <sup>13</sup> / <sub>16</sub>	287
80-20M230F	2AF	N	80	20.051	19.881	20 <sup>7</sup> / <sub>8</sub>	10 <sup>1</sup> / <sub>2</sub>	18	1 <sup>1</sup> / <sub>16</sub>	11 <sup>1</sup> / <sub>16</sub>	8 <sup>1</sup> / <sub>8</sub>	9 <sup>7</sup> / <sub>8</sub>	1 <sup>13</sup> / <sub>16</sub>	280
90-20M230F	2AF	N	90	22.558	22.388	23 <sup>7</sup> / <sub>16</sub>	10 <sup>1</sup> / <sub>2</sub>	20 <sup>9</sup> / <sub>16</sub>	1 <sup>1</sup> / <sub>16</sub>	11 <sup>1</sup> / <sub>16</sub>	8 <sup>1</sup> / <sub>8</sub>	9 <sup>2</sup> / <sub>8</sub>	1 <sup>13</sup> / <sub>16</sub>	319
12-20M230	3A	N	112	28.072	27.902	—	10 <sup>1</sup> / <sub>2</sub>	26 <sup>1</sup> / <sub>4</sub>	1 <sup>1</sup> / <sub>16</sub>	11 <sup>1</sup> / <sub>16</sub>	8 <sup>1</sup> / <sub>8</sub>	9 <sup>1</sup> / <sub>8</sub>	1 <sup>13</sup> / <sub>16</sub>	357
44-20M230	3D	P	144	36.092	35.922	—	13	34 <sup>1</sup> / <sub>4</sub>	11 <sup>1</sup> / <sub>16</sub>	13 <sup>1</sup> / <sub>16</sub>	9 <sup>3</sup> / <sub>8</sub>	9 <sup>7</sup> / <sub>8</sub>	15 <sup>1</sup> / <sub>16</sub>	535
68-20M230	3D	P	168	42.108	41.938	—	13	40 <sup>1</sup> / <sub>4</sub>	11 <sup>1</sup> / <sub>16</sub>	13 <sup>1</sup> / <sub>16</sub>	9 <sup>3</sup> / <sub>8</sub>	9 <sup>7</sup> / <sub>8</sub>	15 <sup>1</sup> / <sub>16</sub>	654
192-20M230	3C	W	192	48.123	47.953	—	16	46	3 <sup>1</sup> / <sub>4</sub>	3 <sup>1</sup> / <sub>4</sub>	11 <sup>3</sup> / <sub>8</sub>	9 <sup>7</sup> / <sub>8</sub>	11 <sup>1</sup> / <sub>2</sub>	935
216-20M230	3C	W	216	54.138	53.968	—	16	52	3 <sup>1</sup> / <sub>4</sub>	3 <sup>1</sup> / <sub>4</sub>	11 <sup>3</sup> / <sub>8</sub>	9 <sup>7</sup> / <sub>8</sub>	11 <sup>1</sup> / <sub>2</sub>	1062

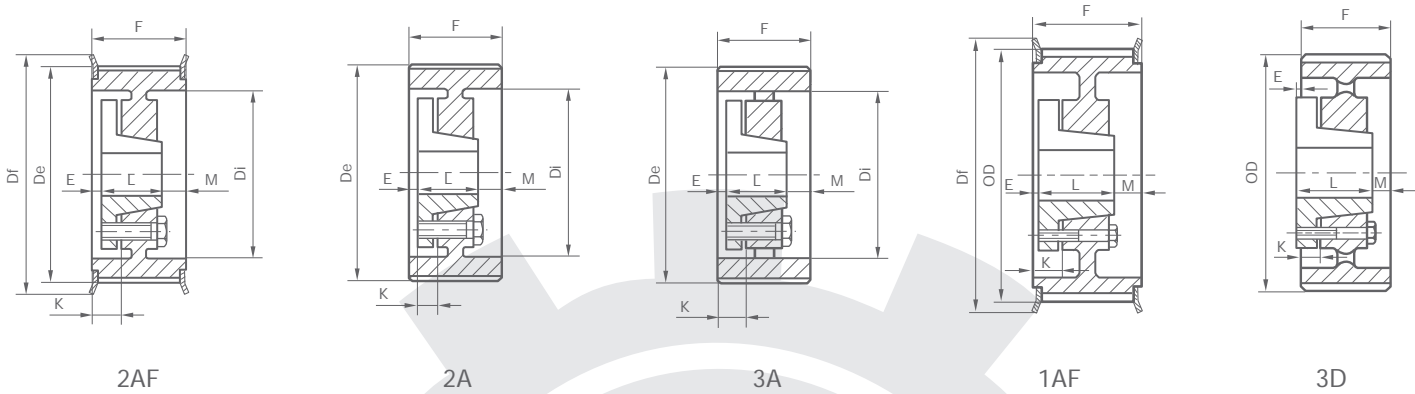

**HTP 20M-290**

SPCFCTN	TYPE	BUSH	Z	Diameter					Dimension					wt (lbs)
				Dp	De	Df	Dm	Di	E	M	L	F	K	
N52-20M290F	1AF	N	52	13.033	12.863	13 <sup>3</sup> / <sub>4</sub>	—	10 <sup>7</sup> / <sub>8</sub>	3/4	2 <sup>3</sup> / <sub>8</sub>	8 <sup>1</sup> / <sub>8</sub>	12 <sup>1</sup> / <sub>4</sub>	2 <sup>1</sup> / <sub>2</sub>	187
N56-20M290F	1AF	N	56	14.036	13.866	14 <sup>3</sup> / <sub>4</sub>	—	11 <sup>7</sup> / <sub>8</sub>	3/4	2 <sup>3</sup> / <sub>8</sub>	8 <sup>1</sup> / <sub>8</sub>	12 <sup>1</sup> / <sub>4</sub>	2 <sup>1</sup> / <sub>2</sub>	223
N60-20M290F	1AF	N	60	15.038	14.868	15 <sup>15</sup> / <sub>16</sub>	—	13 <sup>1</sup> / <sub>16</sub>	3/4	2 <sup>3</sup> / <sub>8</sub>	8 <sup>1</sup> / <sub>8</sub>	12 <sup>1</sup> / <sub>4</sub>	2 <sup>1</sup> / <sub>2</sub>	257
N64-20M290F	1AF	N	64	16.041	15.871	16 <sup>15</sup> / <sub>16</sub>	—	14 <sup>1</sup> / <sub>16</sub>	3/4	2 <sup>3</sup> / <sub>8</sub>	8 <sup>1</sup> / <sub>8</sub>	12 <sup>1</sup> / <sub>4</sub>	2 <sup>1</sup> / <sub>2</sub>	299
N68-20M290F	1AF	N	68	17.044	16.874	17 <sup>15</sup> / <sub>16</sub>	—	15	3/4	2 <sup>3</sup> / <sub>8</sub>	8 <sup>1</sup> / <sub>8</sub>	12 <sup>1</sup> / <sub>4</sub>	2 <sup>1</sup> / <sub>2</sub>	346
N72-20M290F	2AF	N	72	18.046	17.876	18 <sup>7</sup> / <sub>8</sub>	10 <sup>1</sup> / <sub>2</sub>	16	3/4	2 <sup>3</sup> / <sub>8</sub>	8 <sup>1</sup> / <sub>8</sub>	12 <sup>1</sup> / <sub>4</sub>	2 <sup>1</sup> / <sub>2</sub>	311
N80-20M290F	2AF	N	80	20.051	19.881	20 <sup>7</sup> / <sub>8</sub>	10 <sup>1</sup> / <sub>2</sub>	18	3/4	2 <sup>3</sup> / <sub>8</sub>	8 <sup>1</sup> / <sub>8</sub>	12 <sup>1</sup> / <sub>4</sub>	2 <sup>1</sup> / <sub>2</sub>	314
N90-20M290F	2AF	N	90	22.558	22.388	23 <sup>7</sup> / <sub>16</sub>	10 <sup>1</sup> / <sub>2</sub>	20 <sup>9</sup> / <sub>16</sub>	3/4	2 <sup>3</sup> / <sub>8</sub>	8 <sup>1</sup> / <sub>8</sub>	12 <sup>1</sup> / <sub>4</sub>	2 <sup>1</sup> / <sub>2</sub>	359
P112-20M290	2A	P	112	28.072	28.072	—	13	26 <sup>1</sup> / <sub>8</sub>	1/2	2 <sup>3</sup> / <sub>8</sub>	9 <sup>3</sup> / <sub>8</sub>	12 <sup>1</sup> / <sub>4</sub>	2 <sup>1</sup> / <sub>2</sub>	359
P144-20M290	3A	P	144	36.093	35.922	—	13	34	1/2	2 <sup>3</sup> / <sub>8</sub>	9 <sup>3</sup> / <sub>8</sub>	12 <sup>1</sup> / <sub>4</sub>	2 <sup>1</sup> / <sub>2</sub>	637
W168-20M290	3A	W	168	42.108	41.98	—	16	40	7/16	7/16	11 <sup>3</sup> / <sub>8</sub>	12 <sup>1</sup> / <sub>4</sub>	2 <sup>11</sup> / <sub>16</sub>	891
W192-20M290	3A	W	192	48.123	47.953	—	16	46	7/16	7/16	11 <sup>3</sup> / <sub>8</sub>	12 <sup>1</sup> / <sub>4</sub>	2 <sup>11</sup> / <sub>16</sub>	1061
W216-20M290	3A	W	216	54.138	53.968	—	16	52	7/16	7/16	11 <sup>3</sup> / <sub>8</sub>	12 <sup>1</sup> / <sub>4</sub>	2 <sup>11</sup> / <sub>16</sub>	1239

**HTP 20M-340**

SPCFCTN	TYPE	BUSH	Z	Diameter					Dimension					wt (lbs)
				Dp	De	Df	Dm	Di	E	M	L	F	K	
N52-20M340F	1AF	N	52	13.032	12.863	13 <sup>3</sup> / <sub>4</sub>	—	10 <sup>7</sup> / <sub>8</sub>	3/4	5 <sup>3</sup> / <sub>8</sub>	8 <sup>1</sup> / <sub>8</sub>	14 <sup>1</sup> / <sub>4</sub>	2 <sup>1</sup> / <sub>2</sub>	201
N56-20M340F	1AF	N	56	14.036	13.866	14 <sup>3</sup> / <sub>4</sub>	—	11 <sup>7</sup> / <sub>8</sub>	3/4	5 <sup>3</sup> / <sub>8</sub>	8 <sup>1</sup> / <sub>8</sub>	14 <sup>1</sup> / <sub>4</sub>	2 <sup>1</sup> / <sub>2</sub>	239
N60-20M340F	1AF	N	60	15.038	14.868	15 <sup>15</sup> / <sub>16</sub>	—	13 <sup>1</sup> / <sub>16</sub>	3/4	5 <sup>3</sup> / <sub>8</sub>	8 <sup>1</sup> / <sub>8</sub>	14 <sup>1</sup> / <sub>4</sub>	2 <sup>1</sup> / <sub>2</sub>	273
N64-20M340F	1AF	N	64	16.041	18.871	16 <sup>15</sup> / <sub>16</sub>	—	14 <sup>1</sup> / <sub>16</sub>	3/4	5 <sup>3</sup> / <sub>8</sub>	8 <sup>1</sup> / <sub>8</sub>	14 <sup>1</sup> / <sub>4</sub>	2 <sup>1</sup> / <sub>2</sub>	316
N68-20M340F	1AF	N	68	17.044	16.874	17 <sup>15</sup> / <sub>16</sub>	—	15	3/4	5 <sup>3</sup> / <sub>8</sub>	8 <sup>1</sup> / <sub>8</sub>	14 <sup>1</sup> / <sub>4</sub>	2 <sup>1</sup> / <sub>2</sub>	364
N72-20M340F	2AF	N	72	18.046	17.876	18 <sup>2</sup> / <sub>8</sub>	10 <sup>1</sup> / <sub>2</sub>	16	3/4	5 <sup>3</sup> / <sub>8</sub>	8 <sup>1</sup> / <sub>8</sub>	14 <sup>1</sup> / <sub>4</sub>	2 <sup>1</sup> / <sub>2</sub>	330
P80-20M340F	2AF	P	80	20.051	19.881	20 <sup>7</sup> / <sub>8</sub>	13	18	1 <sup>1</sup> / <sub>2</sub>	3 <sup>3</sup> / <sub>8</sub>	9 <sup>3</sup> / <sub>8</sub>	14 <sup>1</sup> / <sub>4</sub>	3 <sup>1</sup> / <sub>2</sub>	406
P90-20M340F	2AF	P	90	22.558	22.388	23 <sup>7</sup> / <sub>16</sub>	13	20 <sup>9</sup> / <sub>16</sub>	1 <sup>1</sup> / <sub>2</sub>	3 <sup>3</sup> / <sub>8</sub>	9 <sup>3</sup> / <sub>8</sub>	14 <sup>1</sup> / <sub>4</sub>	3 <sup>1</sup> / <sub>2</sub>	426
P112-20M340	2A	P	112	28.072	27.902	—	13	26 <sup>1</sup> / <sub>8</sub>	1 <sup>1</sup> / <sub>2</sub>	3 <sup>3</sup> / <sub>8</sub>	9 <sup>3</sup> / <sub>8</sub>	14 <sup>1</sup> / <sub>4</sub>	3 <sup>1</sup> / <sub>2</sub>	543
W144-20M340	3A	W	144	36.092	35.922	—	16	34	3/8	2 <sup>5</sup> / <sub>8</sub>	11 <sup>3</sup> / <sub>8</sub>	14 <sup>1</sup> / <sub>4</sub>	2 <sup>5</sup> / <sub>8</sub>	814
W168-20M340	3A	W	168	42.108	41.938	—	16	40	3/8	2 <sup>5</sup> / <sub>8</sub>	11 <sup>3</sup> / <sub>8</sub>	14 <sup>1</sup> / <sub>4</sub>	2 <sup>5</sup> / <sub>8</sub>	947
S192-20M340	3D	S	192	48.123	47.953	—	17 <sup>3</sup> / <sub>4</sub>	46	2 <sup>1</sup> / <sub>2</sub>	1 <sup>1</sup> / <sub>8</sub>	15 <sup>3</sup> / <sub>4</sub>	14 <sup>1</sup> / <sub>4</sub>	1 <sup>1</sup> / <sub>8</sub>	1368
S216-20M340	3D	S	216	54.138	53.968	—	17 <sup>3</sup> / <sub>4</sub>	52	2 <sup>1</sup> / <sub>2</sub>	1 <sup>1</sup> / <sub>8</sub>	15 <sup>3</sup> / <sub>4</sub>	14 <sup>1</sup> / <sub>4</sub>	1 <sup>1</sup> / <sub>8</sub>	1555